

### Double Spacer Coupling Type SS Single Spacer Coupling Type ES

Spacer Couplings are commonly used where a larger-than-normal shaft separation is desired. This permits servicing of impellers, packing glands, seals, bearing, etc. without disturbing the connected equipment. The two types of spacer couplings—Double Spacer and Single Spacer—vary only in the number of spacer hubs used and offer the user a wide variety of possible shaft separations.

TYPE SS  
DOUBLE SPACER COUPLING

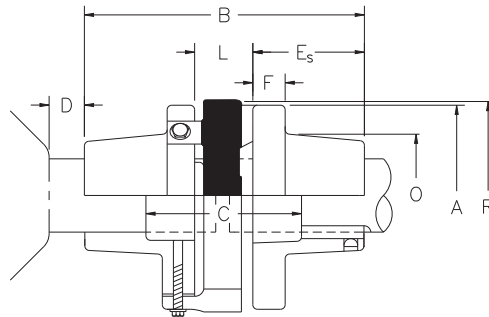

TYPE ES  
SINGLE SPACER COUPLING

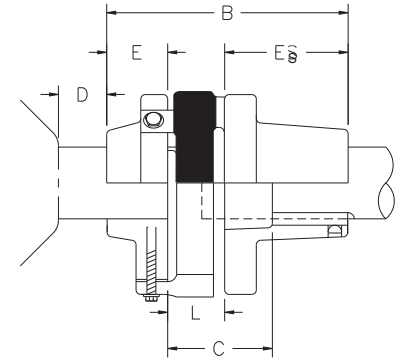

#### DOUBLE SPACER COUPLING With Finished Straight Bores

Coupling Size	Bore with Standard Keyway		Stock Rough Bore S Hub	Hub Sep. L	Shaft Separation C		A	B	D	Es	F	O	R
	Min.	Max.			Min.	Max.							
20	3/4	1 1/4	19/32	1	1/8	6	3 11/16	7 7/8	1/8	3 7/16	5/8	2 5/8	4
30	7/8	1 5/8	3/4	1 1/2	1/8	5 1/2	4 3/8	8 3/8	1/8	3 7/16	5/8	2 13/16	4 5/8
40	7/8	2	3/4	1 5/8	1/8	5 3/8	5 3/8	8 1/2	1/8	3 7/16	1	3 3/16	5 11/16
50	7/8	2 1/4	3/4	2 1/8	1/8	5	6 1/16	9	1/8	3 7/16	1	3 3/8	6 3/4
60	1 1/4	3	1 1/8	2 1/8	1/8	5 1/4	7	9 1/4	1/8	3 9/16	1	4 5/16	7 5/8
70	1 5/8	3 1/8	1 1/2	2 3/8	1/8	6 1/8	8	10 3/8	1/8	4	1	4 9/16	8 11/16
80	1 7/8	4 1/8	1 3/4	3	1/8	7	9 7/16	12 3/8	1/8	4 11/16	1 1/4	5 3/4	10 1/2
90	2 5/8	4 3/4	2 1/2	4 1/8	1/8	7	12 1/8	14	1/8	4 15/16	1 1/2	6 3/4	13 1/16
100	2 7/8	5 3/8	2 3/4	4 1/8	1/8	7	13 7/8	15	1/8	5 7/16	2	7 1/2	15 1/8

#### SINGLE SPACER COUPLING With Finished Straight Bores

Coupling Size	Hub Sep. L	Shaft Separation C		B	E	D
		Min.	Max.			
20	1	1/8	3 1/2	5 1/2	1 1/16	1/8
30	1 1/2	1/8	3 1/2	6 1/4	1 5/16	1/8
40	1 5/8	1/8	3 1/2	6 13/16	1 3/4	1/8
50	2 1/8	1/8	3 9/16	7 9/16	2	1/8
60	2 1/8	1/8	3 11/16	7 11/16	2	1/8
70	2 3/8	1/8	4 1/4	8 1/2	2 1/8	1/8
80	3	1/8	5	10 3/8	2 11/16	1/8
90	4 1/8	1/8	5 9/16	12 9/16	3 1/2	1/8
100	4 1/8	1/8	5 9/16	13 9/16	4	1/8

Coupling Size	S Hub No Bore		E Hub No Bore		Element W/ Fastener	
	Part No.	Wt. (lbs.)	Part No.	Wt. (lbs.)	Part No.	Wt. (lbs.)
20	20 SHUB	1	20 EHUB	1	20 ELEMENT	1
30	30 SHUB	1	30 EHUB	1	30 ELEMENT	1
40	40 SHUB	2	40 EHUB	2	40 ELEMENT	1
50	50 SHUB	3	50 EHUB	3	50 ELEMENT	2
60	60 SHUB	4	60 EHUB	3	60 ELEMENT	3
70	70 SHUB	6	70 EHUB	4	70 ELEMENT	5
80	80 SHUB	11	80 EHUB	8	80 ELEMENT	9
90	90 SHUB	18	90 EHUB	15	90 ELEMENT	16
100	100 SHUB	34	100 EHUB	29	100 ELEMENT	18

